

BREAKSTEM RIVET RAS SERIES

Head Type	Dome Head
Material (body / mandrel)	5052 Aluminium Alloy / Steel
Finish (body / mandrel)	Polished / Zinc Plate

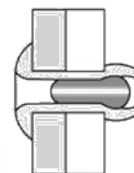
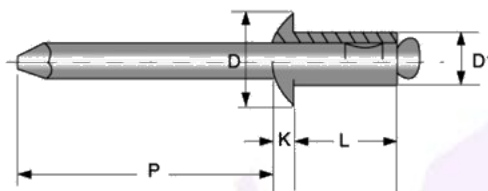

Dimensions in millimetres.

Part Number	Rivet Diameter (D1) nom.	Hole Size	Length (L) max.	Grip Range	Mandrel Length (P) Min.	Head Diameter (D) max.	Head Thickness (K) max.	Standard Strength (kN) typ.	
								Shear	Tensile
RAS32	2.4 3/32"	2.5 ~ 2.6	6.4	0.5 ~ 3.0	25.4	4.8	0.81	0.31	0.36
RAS34			9.5	3.0 ~ 5.0					
RAS36			12.7	6.0 ~ 9.0					
RAS41	3.2 1/8"	3.3 ~ 3.4	5.4	0.5 ~ 2.0	27	6.4	1.02	0.53	0.67
RAS42			7.0	2.0 ~ 4.0					
RAS43			8.6	3.0 ~ 5.0					
RAS44			10.2	5.0 ~ 7.0					
RAS45			11.7	6.0 ~ 8.0					
RAS46			13.3	8.0 ~ 10.0					
RAS48			16.5	11.0 ~ 13.0					
RAS410			19.7	14.0 ~ 16.0					
RAS52			4.0 5/32"	4.1 ~ 4.2					
RAS53	9.2	3.0 ~ 5.0							
RAS54	10.8	4.0 ~ 6.0							
RAS56	14.0	8.0 ~ 10.0							
RAS58	17.1	11.0 ~ 13.0							
RAS510	20.3	14.0 ~ 16.0							
RAS516	29.8	24.0 ~ 26.0							
RAS62	4.8 3/16"	4.9 ~ 5.0	8.3	2.0 ~ 3.0	27	9.5	1.52	1.16	1.43
RAS63			9.8	2.0 ~ 4.0					
RAS64			11.4	4.0 ~ 6.0					
RAS66			14.6	7.0 ~ 9.0					
RAS68			17.8	10.0 ~ 12.0					
RAS610			21.0	13.0 ~ 16.0					
RAS612			24.1	16.0 ~ 19.0					
RAS614			27.3	19.0 ~ 22.0					
RAS616			30.5	21.0 ~ 25.0					
RAS618			33.7	24.0 ~ 28.0					
RAS622			40.0	33.0 ~ 35.0					
RAS82	6.4 1/4"	6.5 ~ 6.6	9.5	1.0 ~ 3.0	32	12.7	2.03	2.05	2.50
RAS84			12.7	3.0 ~ 5.0					
RAS86			15.9	5.0 ~ 8.0					
RAS88			19.1	9.0 ~ 12.0					
RAS810			22.2	13.0 ~ 15.0					
RAS812			25.4	15.0 ~ 18.0					
RAS814			28.6	18.0 ~ 21.0					
RAS816			31.8	21.0 ~ 24.0					
RAS818			34.9	25.0 ~ 28.0					

PLEASE NOTE – NOT ALL STYLES & SIZES ARE HELD IN STOCK AT ALL TIMES. PLEASE CONTACT US TO CHECK AVAILABILITY. MINIMUM ORDER QUANTITIES APPLY.

Dafra Fastening Systems - Rivets Rivnuts & Tooling
7 Joyner Street Moorabbin Vic 3189

Phone (03) 9555 6872 | Fax (03) 9555 0803
Email sales@dafra.com.au | dafra.com.au

#DAFRA
in Riveting Stuff
dafra.com.au

BREAKSTEM RIVET RSS SERIES

Head Type	Dome Head
Material (body / mandrel)	Carbon Steel / Carbon Steel
Finish (body / mandrel)	Zinc Plate / Zinc Plate

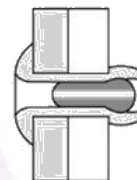
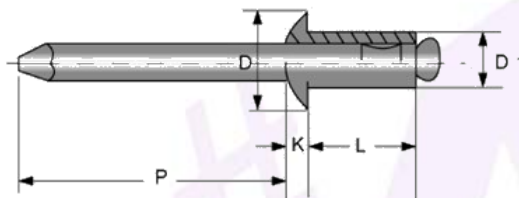

Dimensions in millimetres.

Part Number	Rivet Diameter (D1) nom.	Hole Size +0.1	Length (L) max.	Grip Range	Head Diameter (H) max.	Head Thickness (K) max.	Standard Strength (kN) typ.	
							Shear	Tensile
RSS41	3.2 1/8"	3.3 ~ 3.4	4.8	0.5 ~ 2.0	6.4	1.1	1.16	1.38
RSS42			6.4	2.0 ~ 4.0				
RSS43			8.0	3.0 ~ 5.0				
RSS44			9.5	5.0 ~ 7.0				
RSS45			11.2	6.0 ~ 8.0				
RSS46			12.7	8.0 ~ 10.0				
RSS48			15.9	11.0 ~ 13.0				
RSS52	4.0 5/32"	4.1 ~ 4.2	7.0	1.0 ~ 3.0	8.0	1.3	1.65	2.10
RSS53			8.6	3.0 ~ 5.0				
RSS54			10.2	4.0 ~ 6.0				
RSS55			12.0	6.0 ~ 8.0				
RSS56			13.3	8.0 ~ 10.0				
RSS58			16.5	11.0 ~ 13.0				
RSS62	4.8 3/16"	4.9 ~ 5.0	7.6	2.0 ~ 3.0	9.6	1.6	2.40	3.03
RSS63			9.0	2.0 ~ 4.0				
RSS64			10.8	4.0 ~ 6.0				
RSS66			14.0	7.0 ~ 9.0				
RSS68			17.2	10.0 ~ 12.0				
RSS610			20.0	13.0 ~ 16.0				

PLEASE NOTE – NOT ALL STYLES & SIZES ARE HELD IN STOCK AT ALL TIMES. PLEASE CONTACT US TO CHECK AVAILABILITY. MINIMUM ORDER QUANTITIES APPLY.

BREAKSTEM RIVET RSTST SERIES

Head Type	Dome Head
Material (body / mandrel)	Stainless Steel / Stainless Steel
Finish (body / mandrel)	Polished / Polished

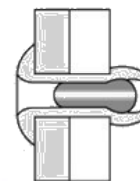
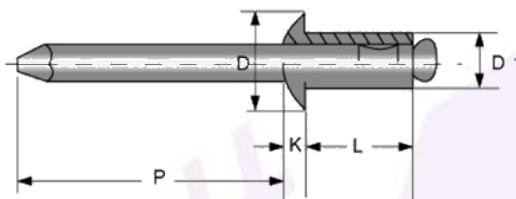

Dimensions in millimetres.

Part Number	Rivet Diameter (D1) nom.	Hole Size	Length (L) max.	Grip Range	Mandrel Length (P) Min.	Head Diameter (D) max.	Head Thickness (K) max.	Standard Strength (kN) typ.	
								Shear	Tensile
RSTST41	3.2 1/8"	3.3 ~ 3.4	5.4	0.5 ~ 2.0	27	6.4	1.02	1.87	2.36
RSTST42			7.0	2.0 ~ 4.0					
RSTST43			8.6	3.0 ~ 5.0					
RSTST44			10.2	5.0 ~ 7.0					
RSTST45			11.7	6.0 ~ 8.0					
RSTST46			13.3	8.0 ~ 10.0					
RSTST48			16.5	11.0 ~ 13.0					
RSTST52	4.0 5/32"	4.1 ~ 4.2	7.6	1.0 ~ 3.0	27	7.9	1.27	2.90	3.65
RSTST53			9.2	3.0 ~ 5.0					
RSTST54			10.8	4.0 ~ 6.0					
RSTST56			14.0	8.0 ~ 10.0					
RSTST58			17.1	11.0 ~ 13.0					
RSTST510			20.3	14.0 ~ 16.0					
RSTST512			23.5	15.0 ~ 18.0					
RSTST514	26.7	19.0 ~ 23.0							
RSTST62	4.8 3/16"	4.9 ~ 5.0	8.3	2.0 ~ 3.0	27	9.5	1.52	4.23	5.34
RSTST63			9.8	2.0 ~ 4.0					
RSTST64			11.4	4.0 ~ 6.0					
RSTST66			14.6	7.0 ~ 9.0					
RSTST68			17.8	10.0 ~ 12.0					
RSTST610			21.0	13.0 ~ 16.0					
RSTST612			24.1	16.0 ~ 19.0					
RSTST614			27.3	19.0 ~ 22.0					
RSTST616			30.5	21.0 ~ 25.0					
RSTST618			33.7	24.0 ~ 28.0					
RSTST620			36.8	28.0 ~ 31.0					
RSTST622	40.0	33.0 ~ 35.0							
RSTST82	6.4 1/4"	6.5 ~ 6.6	9.5	1.0 ~ 3.0	27	12.7	2.03	7.57	9.35
RSTST84			12.7	3.0 ~ 5.0					
RSTST86			15.9	5.0 ~ 8.0					
RSTST88			19.1	9.0 ~ 12.0					
RSTST810			22.2	13.0 ~ 15.0					
RSTST812			25.4	15.0 ~ 18.0					
RSTST814			28.6	18.0 ~ 21.0					
RSTST816			31.8	21.0 ~ 24.0					
RSTST818			34.9	25.0 ~ 28.0					
RSTST820			38.1	28.0 ~ 33.0					

PLEASE NOTE – NOT ALL STYLES & SIZES ARE HELD IN STOCK AT ALL TIMES. PLEASE CONTACT US TO CHECK AVAILABILITY. MINIMUM ORDER QUANTITIES APPLY.

Dafra Fastening Systems - Rivets Rivnuts & Tooling
7 Joyner Street Moorabbin Vic 3189

Phone (03) 9555 6872 | Fax (03) 9555 0803
Email sales@dafra.com.au | dafra.com.au

#DAFRA
in Riveting Stuff
dafra.com.au

BREAKSTEM RIVET RASLF SERIES

Head Type	Flange Head
Material (body / mandrel)	5052 Aluminium Alloy / Steel
Finish (body / mandrel)	Polished / Zinc Plate

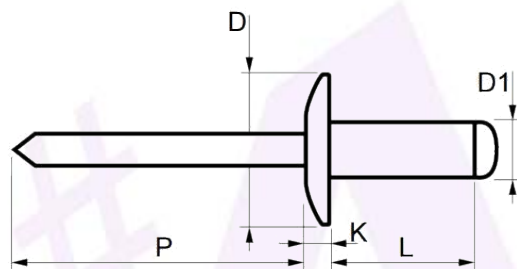

Dimensions in millimetres.

Part Number	Rivet Diameter (D1) nom.	Hole Size	Length (L) max.	Grip Range	Mandrel Length (P) Min.	Head Diameter (D) max.	Head Thickness (K) max.	Standard Strength (kN) typ.	
								Shear	Tensile
RASLF42	3.2 1/8"	3.3 ~ 3.4	7.0	2.0 ~ 4.0	27	9.5	1.65	0.53	0.67
RASLF43			8.6	3.0 ~ 5.0					
RASLF44			10.2	5.0 ~ 7.0					
RASLF45			11.7	6.0 ~ 8.0					
RASLF46			13.3	8.0 ~ 10.0					
RASLF48			16.5	11.0 ~ 13.0					
RASLF410			19.7	14.0 ~ 16.0					
RASLF52	4.0 5/32"	4.1 ~ 4.2	7.6	1.0 ~ 3.0	27	12.0	1.90	0.85	1.02
RASLF53			9.2	3.0 ~ 5.0					
RASLF54			10.8	4.0 ~ 6.0					
RASLF56			14.0	8.0 ~ 10.0					
RASLF58			17.1	11.0 ~ 13.0					
RASLF510			20.3	14.0 ~ 16.0					
RASLF62	4.8 3/16"	4.9 ~ 5.0	8.3	2.0 ~ 3.0	27	16.0	2.33	1.16	1.43
RASLF63			9.8	2.0 ~ 4.0					
RASLF64			11.4	4.0 ~ 6.0					
RASLF66			14.6	7.0 ~ 9.0					
RASLF68			17.8	10.0 ~ 12.0					
RASLF610			21.0	13.0 ~ 16.0					
RASLF612			24.1	16.0 ~ 19.0					
RASLF614			27.3	19.0 ~ 22.0					
RASLF616			30.5	21.0 ~ 25.0					
RASLF618			33.7	24.0 ~ 28.0					

PLEASE NOTE – NOT ALL STYLES & SIZES ARE HELD IN STOCK AT ALL TIMES. PLEASE CONTACT US TO CHECK AVAILABILITY. MINIMUM ORDER QUANTITIES APPLY.

Dafra Fastening Systems - Rivets Rivnuts & Tooling
7 Joyner Street Moorabbin Vic 3189

Phone (03) 9555 6872 | Fax (03) 9555 0803
Email sales@dafra.com.au | dafra.com.au

#DAFRA
in Riveting Stuff
dafra.com.au

BREAKSTEM RIVET RASC SERIES

Head Type	CSK Head
Material (body / mandrel)	5052 Aluminium Alloy / Steel
Finish (body / mandrel)	Polished / Zinc Plate

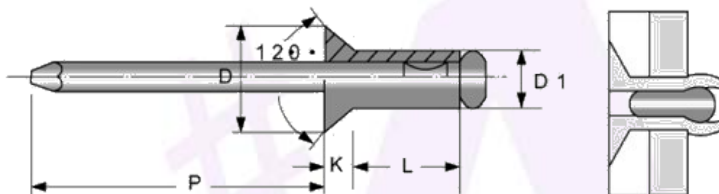

Dimensions in millimetres.

Part Number	Rivet Diameter (D1) nom.	Hole Size	Length (L) max.	Grip Range	Mandrel Length (P) Min.	Head Diameter (D) max.	Head Thickness (K) max.	Standard Strength (kN) typ.	
								Shear	Tensile
RASC42	3.2 1/8"	3.3 ~ 3.4	7.0	2.0 ~ 4.0	27	5.6	.79	0.53	0.67
RASC43			8.6	3.0 ~ 5.0					
RASC44			10.2	5.0 ~ 7.0					
RASC45			11.7	6.0 ~ 8.0					
RASC46			13.3	8.0 ~ 10.0					
RASC48			16.5	11.0 ~ 13.0					
RASC53	4.0 5/32"	4.1 ~ 4.2	9.2	3.0 ~ 5.0	27	7.1	1.02	0.85	1.02
RASC54			10.8	4.0 ~ 6.0					
RASC56			14.0	8.0 ~ 10.0					
RASC58			17.1	11.0 ~ 13.0					
RASC63	4.8 3/16"	4.9 ~ 5.0	9.8	2.0 ~ 4.0	27	8.8	1.27	1.16	1.43
RASC64			11.4	4.0 ~ 6.0					
RASC66			14.6	7.0 ~ 9.0					
RASC68			17.8	10.0 ~ 12.0					
RASC610			21.0	13.0 ~ 16.0					

PLEASE NOTE – NOT ALL STYLES & SIZES ARE HELD IN STOCK AT ALL TIMES. PLEASE CONTACT US TO CHECK AVAILABILITY. MINIMUM ORDER QUANTITIES APPLY.

Dafra Fastening Systems - Rivets Rivnuts & Tooling
7 Joyner Street Moorabbin Vic 3189

Phone (03) 9555 6872 | Fax (03) 9555 0803
Email sales@dafra.com.au | dafra.com.au

#DAFRA
in Riveting Stuff
dafra.com.au

BREAKSTEM RIVET RTA SERIES

Head Type	Dome Head
Material (body / mandrel)	5052 Aluminium Alloy / Carbon Steel
Finish (body / mandrel)	Natural / Zinc Plate

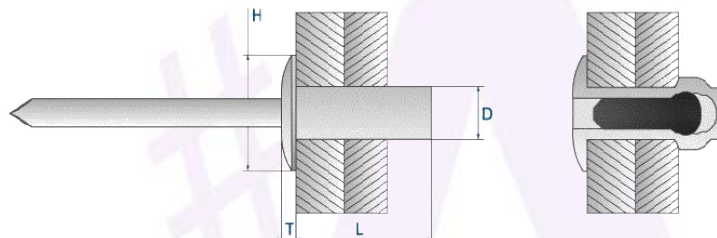

Dimensions in millimetres.

Part Number	Rivet Diameter (D1) nom.	Hole Size +0.1	Length (L) max.	Grip Range	Head Diameter (D) max.	Head Thickness (K) max.	Standard Strength (kN) typ.	
							Shear	Tensile
RTA41	3.2 1/8"	3.3 ~ 3.4	7.5	0.5 ~ 2.0	6.4	1.3	1.07	1.25
RTA42			9.1	2.0 ~ 4.0				
RTA43			10.7	3.0 ~ 5.0				
RTA44			12.3	5.0 ~ 7.0				
RTA45			13.9	6.0 ~ 8.0				
RTA46			15.5	8.0 ~ 10.0				
RTA48			18.7	11.0 ~ 13.0				
RTA52	4.0 5/32"	4.1 ~ 4.2	9.5	1.0 ~ 3.0	8.3	1.7	1.56	2.14
RTA53			11.1	3.0 ~ 5.0				
RTA54			12.7	4.0 ~ 6.0				
RTA55			14.3	6.0 ~ 8.0				
RTA56			15.9	8.0 ~ 10.0				
RTA58			19.1	11.0 ~ 13.0				
RTA62	4.8 3/16"	4.9 ~ 5.0	10.3	2.0 ~ 3.0	10.0	2.0	2.23	3.07
RTA63			11.9	2.0 ~ 4.0				
RTA64			13.5	4.0 ~ 6.0				
RTA66			16.7	7.0 ~ 9.0				
RTA68			19.8	10.0 ~ 12.0				
RTA610			23.0	13.0 ~ 16.0				

PLEASE NOTE – NOT ALL STYLES & SIZES ARE HELD IN STOCK AT ALL TIMES. PLEASE CONTACT US TO CHECK AVAILABILITY. MINIMUM ORDER QUANTITIES APPLY.

Dafra Fastening Systems - Rivets Rivnuts & Tooling
7 Joyner Street Moorabbin Vic 3189

Phone (03) 9555 6872 | Fax (03) 9555 0803
Email sales@dafra.com.au | dafra.com.au

#DAFRA
in Riveting Stuff
dafra.com.au

MULTIGRIP RIVET MGAVAS SERIES

Head Type	Dome Head
Material (body / mandrel)	Aluminium Alloy / Carbon Steel
Finish (body / mandrel)	Polished / Zinc Plate

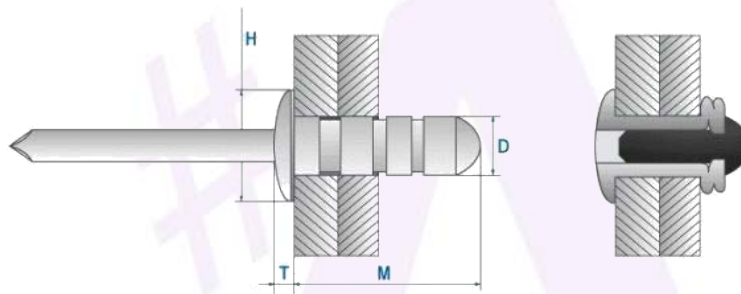

Dimensions in millimetres.

Part Number	Rivet Diameter (D) nom.	Hole Size	Length (M) max.	Grip Range	Head Diameter (H) max.	Head Thickness (T) max.	Standard Strength (kN) typ.	
							Shear	Tensile
MGAVAS0410	3.2 1/8"	3.3 ~ 3.4	10.4	0.8 ~ 4.8	6.7	1.3	0.70	1.00
MGAVAS0414			13.6	4.0 ~ 7.9				
MGAVAS0512	4.0 5/32"	4.1 ~ 4.2	12.5	1.2 ~ 6.3	8.2	1.6	1.00	1.60
MGAVAS0516			16.2	4.0 ~ 9.5				
MGAVAS0613	4.8 3/16"	4.9 ~ 5.0	14.0	1.6 ~ 6.3	10.1	1.8	1.30	2.30
MGAVAS0619			18.8	4.8 ~ 11.1				
MGAVAS0621			20.3	4.8 ~ 12.7				
MGAVAS0631			28.3	12.7 ~ 19.8				
MGAVAS08165	6.40 1/4"	6.6 ~ 6.9	16.8	2.0 ~ 9.0	13.5	2.7	3.1	2.5

PLEASE NOTE – NOT ALL STYLES & SIZES ARE HELD IN STOCK AT ALL TIMES. PLEASE CONTACT US TO CHECK AVAILABILITY. MINIMUM ORDER QUANTITIES APPLY.

MULTIGRIP RIVET MGAVASC SERIES

Head Type	Countersunk 120°
Material (body / mandrel)	Aluminium Alloy / Carbon Steel
Finish (body / mandrel)	Polished / Zinc Plate

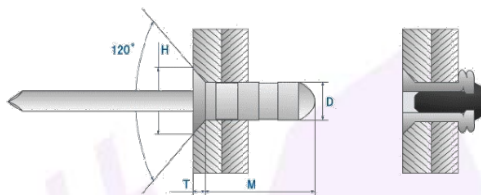

Dimensions in millimetres.

Part Number	Rivet Diameter (D) nom.	Hole Size	Length (M) max.	Grip Range	Head Diameter (H) max.	Head Thickness (T) max.	Standard Strength (kN) typ.	
							Shear	Tensile
MGAVASC0412	3.2 1/8"	3.3 ~ 3.4	12.3	2.4 ~ 6.3	5.5	1.3	0.70	0.90
MGAVASC0514	4.0 5/32"	4.1 ~ 4.2	14.3	2.8 ~ 7.9	6.5	1.4	1.10	1.30
MGAVASC0615	4.8 3/16"	4.9 ~ 5.0	15.5	3.2 ~ 7.9	9.0	1.8	1.30	2.30
MGAVASC0621			20.4	6.3 ~ 12.7				

PLEASE NOTE – NOT ALL STYLES & SIZES ARE HELD IN STOCK AT ALL TIMES. PLEASE CONTACT US TO CHECK AVAILABILITY. MINIMUM ORDER QUANTITIES APPLY.

MULTIGRIP RIVET MGAVASLF SERIES

Head Type	Large Flange
Material (body / mandrel)	Aluminium Alloy / Carbon Steel
Finish (body / mandrel)	Polished / Zinc Plate

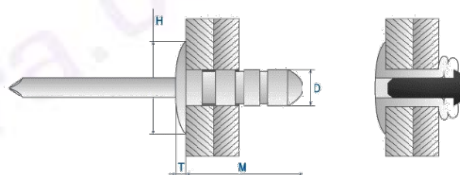

Dimensions in millimetres.

Part Number	Rivet Diameter (D) nom.	Hole Size	Length (M) max.	Grip Range	Head Diameter (H) max.	Head Thickness (T) max.	Standard Strength (kN) typ.	
							Shear	Tensile
MGAVASLF0410	3.2 1/8"	3.3 ~ 3.4	9.0	0.5 ~ 4.5	9.0	1.4	0.6	0.9
MGAVASLF0613	4.8 3/16"	4.9 ~ 5.0	13.9	1.6 ~ 6.3	16.2	2.2	1.30	2.1
MGAVASLF0621			20.2	6.4 ~ 12.7				
MGAVASLF0631			28.2	12.7 ~ 19.8				

PLEASE NOTE – NOT ALL STYLES & SIZES ARE HELD IN STOCK AT ALL TIMES. PLEASE CONTACT US TO CHECK AVAILABILITY. MINIMUM ORDER QUANTITIES APPLY.

MULTIGRIP RIVET MGAVSS SERIES

Head Type	Dome Head
Material (body / mandrel)	Carbon Steel / Carbon Steel
Finish (body / mandrel)	Zinc Plate / Zinc Plate

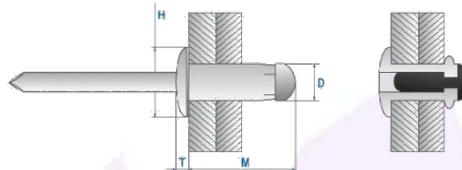

Dimensions in millimetres.

Part Number	Rivet Diameter (D) nom.	Hole Size	Length (M) max.	Grip Range	Head Diameter (H) max.	Head Thickness (T) max.	Standard Strength (kN) typ.	
							Shear	Tensile
MGAVSS0411	3.2 1/8"	3.2 ~ 3.4	11.4	1.1 ~ 4.0	7.24	0.94	1.3	1.7
MGAVSS0514	4.0 5/32"	4.1 ~ 4.2	13.6	1.4 ~ 5.0	8.13	1.32	1.9	2.3
MGAVSS0612	4.8 3/16"	4.9 ~ 5.0	13.9	1.2 ~ 4.8	9.78	1.88	3.6	3.3
MGAVSS0616			16.2	4.0 ~ 6.3				

PLEASE NOTE – NOT ALL STYLES & SIZES ARE HELD IN STOCK AT ALL TIMES. PLEASE CONTACT US TO CHECK AVAILABILITY. MINIMUM ORDER QUANTITIES APPLY.

FOLDING RIVET MGBBAA SERIES

Head Type	Dome Head
Material (body / mandrel)	AL Alloy / AL Alloy
Finish (body / mandrel)	Natural / Natural

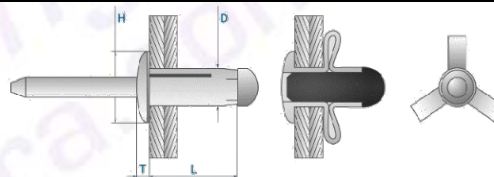

Dimensions in millimetres.

Part Number	Rivet Diameter (D) nom.	Hole Size	Length (M) max.	Grip Range	Head Diameter (H) max.	Head Thickness (T) max.	Standard Strength (Kn) TYP.	
							Shear	Tensile
MGBBAA0516	4.0 5/32"	4.2 ~ 4.5	16.0	1.0 ~ 3.0	8.2	1.6	0.6	1.0
MGBBAA0523			21.0	1.0 ~ 7.0				
MGBBAA0619	4.8 3/16"	5.0 ~ 5.2	18.1	1.0 ~ 4.0	10.1	2.1	0.8	1.1
MGBBAA0625			23.3	1.0 ~ 9.0				
MGBBAA0630			27.1	4.0 ~ 12.0				

PLEASE NOTE – NOT ALL STYLES & SIZES ARE HELD IN STOCK AT ALL TIMES. PLEASE CONTACT US TO CHECK AVAILABILITY. MINIMUM ORDER QUANTITIES APPLY.

MULTIGRIP RIVET MGABSS SERIES

Head Type	Dome Head
Material (body / mandrel)	Steel / Steel
Finish (body / mandrel)	Zinc Plate / Zinc Plate

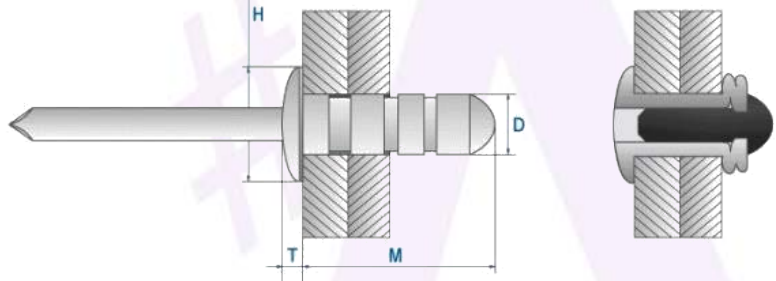

Dimensions in millimetres.

Part Number	Rivet Diameter (D) nom.	Hole Size	Length (M) max.	Grip Range	Head Diameter (H) max.	Head Thickness (T) max.	Standard Strength (Kn) TYP.	
							Shear	Tensile
MGABSS0408	3.2 1/8"	3.3 ~ 3.4	9.1	1.0 ~ 3.0	6.8	1.4	1.2	1.3
MGABSS0411			11.7	3.0 ~ 5.0			1.7	
MGABSS0414			14.0	5.0 ~ 7.0			2.5	
MGABSS0509	4.0 5/32"	4.1 ~ 4.3	10.4	1.0 ~ 3.0	8.0	1.4	2.4	2.8
MGABSS0512			12.5	3.0 ~ 5.0			3.5	
MGABSS0516			15.1	5.0 ~ 7.0			4.1	
MGABSS0611	4.8 3/16"	4.9 ~ 5.1	12.9	1.5 ~ 3.5	9.6	1.5	3.6	3.8
MGABSS0614			15.5	3.5 ~ 6.0			4.2	
MGABSS0618			18.5	6.0 ~ 8.5			5.6	

PLEASE NOTE – NOT ALL STYLES & SIZES ARE HELD IN STOCK AT ALL TIMES. PLEASE CONTACT US TO CHECK AVAILABILITY. MINIMUM ORDER QUANTITIES APPLY.

MULTIGRIP RIVET MGANSTST SERIES

Head Type	Dome Head
Material (body / mandrel)	Stainless Steel / Stainless Steel
Finish (body / mandrel)	Polished / Natural

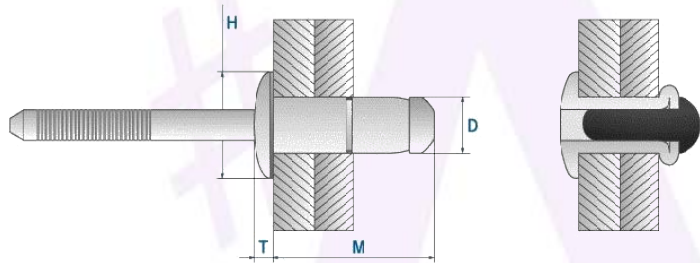

Dimensions in millimetres.

Part Number	Rivet Diameter (D) nom.	Hole Size	Length (M) max.	Grip Range	Head Diameter (H) max.	Head Thickness (T) max.	Standard Strength (Kn) TYP.	
							Shear	Tensile
MGANSTST0408	3.2 1/8"	3.3 ~ 3.4	8.9	1.0 ~ 3.0	6.4	0.9	1.63	2.04
MGANSTST0411			11.4	3.0 ~ 5.0				
MGANSTST0414			13.6	5.0 ~ 7.0				
MGANSTST0509	4.0 5/32"	4.1 ~ 4.3	10.1	1.0 ~ 3.0	7.8	1.3	5.3	4.08
MGANSTST0512			12.5	3.0 ~ 5.0				
MGANSTST0516			15.1	5.0 ~ 7.0				
MGANSTST0611	4.8 3/16"	4.9 ~ 5.1	12.9	1.5 ~ 3.5	9.3	1.4	5.6	5.1
MGANSTST0614			15.5	3.5 ~ 6.0				
MGANSTST0618			18.5	6.0 ~ 8.5				

PLEASE NOTE – NOT ALL STYLES & SIZES ARE HELD IN STOCK AT ALL TIMES. PLEASE CONTACT US TO CHECK AVAILABILITY. MINIMUM ORDER QUANTITIES APPLY.

MULTIGRIP RIVET MGSVSS SERIES

Head Type	Dome Head
Material (body / mandrel)	Carbon Steel / Carbon Steel
Finish (body / mandrel)	Zinc Plate / Zinc Plate

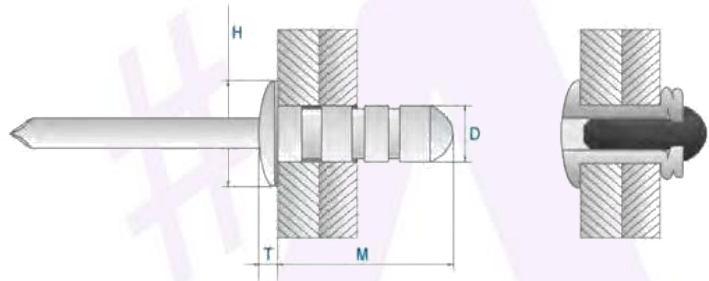

Dimensions in millimetres.

Part Number	Rivet Diameter (D) nom.	Hole Size	Length (M) max.	Grip Range	Head Diameter (H) max.	Head Thickness (T) max.	Standard Strength (Kn) TYP.	
							Shear	Tensile
MGSVSS0414	3.2 1/8"	3.3 ~ 3.4	14.5	1.0 ~ 6.0	7.3	1.0	0.9	1.2
MGSVSS0511	4.0 5/32"	4.1 ~ 4.2	12.0	1.0 ~ 5.0	8.2	1.4	1.5	1.8
MGSVSS0516			16.0	2.0 ~ 8.0				
MGSVSS0612	4.8 3/16"	4.9 ~ 5.0	12.2	1.5 ~ 5.1	10.1	1.6	2.6	2.9
MGSVSS0614			13.8	1.5 ~ 6.3				
MGSVSS0618			17.1	1.5 ~ 9.0				
MGSVSS0622			20.1	6.3 ~ 12.7				
MGSVSS08165	6.40 1/4"	6.6 ~ 6.9	16.8	2.0 ~ 9.0	13.5	2.7	3.1	3.6

PLEASE NOTE – NOT ALL STYLES & SIZES ARE HELD IN STOCK AT ALL TIMES. PLEASE CONTACT US TO CHECK AVAILABILITY. MINIMUM ORDER QUANTITIES APPLY.

MULTIGRIP RIVET MGSVSTST SERIES

Head Type	Dome Head
Material (body / mandrel)	Stainless Steel / Stainless Steel
Finish (body / mandrel)	Natural / Natural

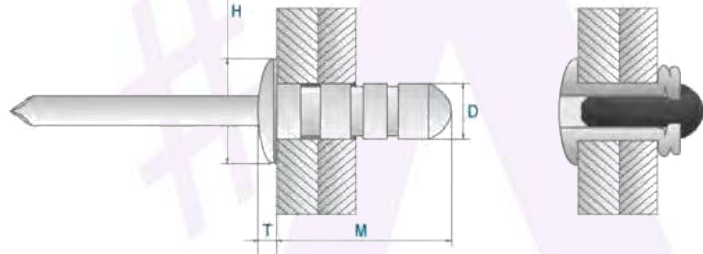
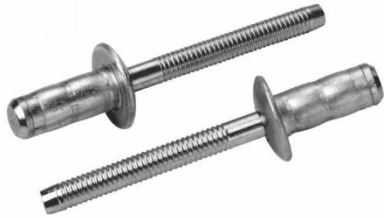

Dimensions in millimetres.

Part Number	Rivet Diameter (D) nom.	Hole Size	Length (M) max.	Grip Range	Head Diameter (H) max.	Head Thickness (T) max.	Standard Strength (Kn) TYP.	
							Shear	Tensile
MGSVSTST0414	3.2 1/8"	3.3 ~ 4.4	14.5	1.0 ~ 6.0	7.3	1.0	1.6	1.9
MGSVSTST0516	4.0 5/32"	4.1 ~ 4.2	16.0	2.0 ~ 8.0	8.2	1.4	2.4	3.2
MGSVSTST0618	4.8 3/16"	4.9 ~ 5.0	17.1	1.5 ~ 9.0	10.1	1.6	4.1	4.5

PLEASE NOTE – NOT ALL STYLES & SIZES ARE HELD IN STOCK AT ALL TIMES. PLEASE CONTACT US TO CHECK AVAILABILITY. MINIMUM ORDER QUANTITIES APPLY.